

**NOTICE** - This drawing is a part of the proprietary and/or confidential information of the manufacturer. It is not to be distributed, copied, or used in any way without the express written permission of the manufacturer. Any unauthorized use or disclosure of this information shall be held to be a violation of applicable laws and regulations and may result in civil and/or criminal penalties in any given jurisdiction.

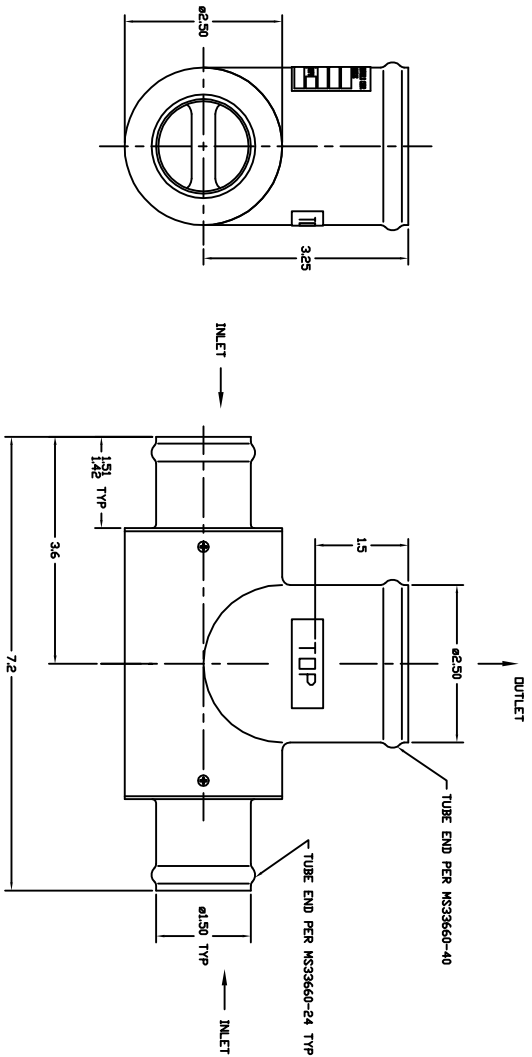

-1 ASSY.

NOTES CONT'D.

7. OPERATING PARAMETERS

- LEAKAGE @ 6 PSIG & 72°F
- OPERATING TEMPERATURE
- INTERNAL @ 26 CFM TOTAL (MAX)
- OPERATING TEMPERATURE
- NORMAL 300°F
- MAX 300°F
- FLOW EACH SOURCE
- NORMAL 6 LBS/MIN
- MAX 8 LBS/MIN

8. THIS VALVE ASSY SHALL BE SUITABLE FOR ITS INTENDED USE TO BRING ENVIRONMENTAL BLEED AIR FROM TWO SOURCES TO A COMMON MOUNTED D AND PREVENT BACK FLOW INTO THE SUPPLY LINE SHOULD EITHER SOURCE SHUTDOWN.

9. THE UNIT SHALL BE CAPABLE OF WITHSTANDING IN-FLIGHT OPERATIONAL LOADS UP TO 9 G'S IN ANY DIRECTION WITHOUT FAILURE.

10. ASC P/N 3001A100-1 IS EQUIVALENT TO RAYTHEON P/N 101-384173-17  
ASC P/N 3001A100-3 IS EQUIVALENT TO RAYTHEON P/N 101-384173-19

CL. NO.	REV.	REVISION DESCRIPTION	DATE	APP'D
ASC1653	A	ADDED -5 & -7 COMFIGS.	7-26-00	DS
ASC1662	B	SHOWN LABELS	8-7-00	DS
ASC1705	C	UPDATED -9 & -11 COMFIGS. PRINTED -1 & -3 PICTORIALY	10-9-00	DS
ASC1846	D	SHFTS 1 & 2 NOTE TO: DELETED REF TO -17, -19 WAS -12, -15 RESPECTIVELY. SHFTS 3-6 NOTE TO: REF. AS ALI, TO -1, -3	5-9-01	DS

REV	DATE	DESCRIPTION	BY	CHKD	APP'D
1					
2					
3					
4					
5					
6					
7					
8					
9					
10					

INTL. SPEC.	ENGLISH	FINISH SPEC.
SCALE	1:1	SHR 1 OF 6
<b>VALVE ASSY - CHECK ENVIRONMENTAL BLEED AIR</b> 3001A100		